

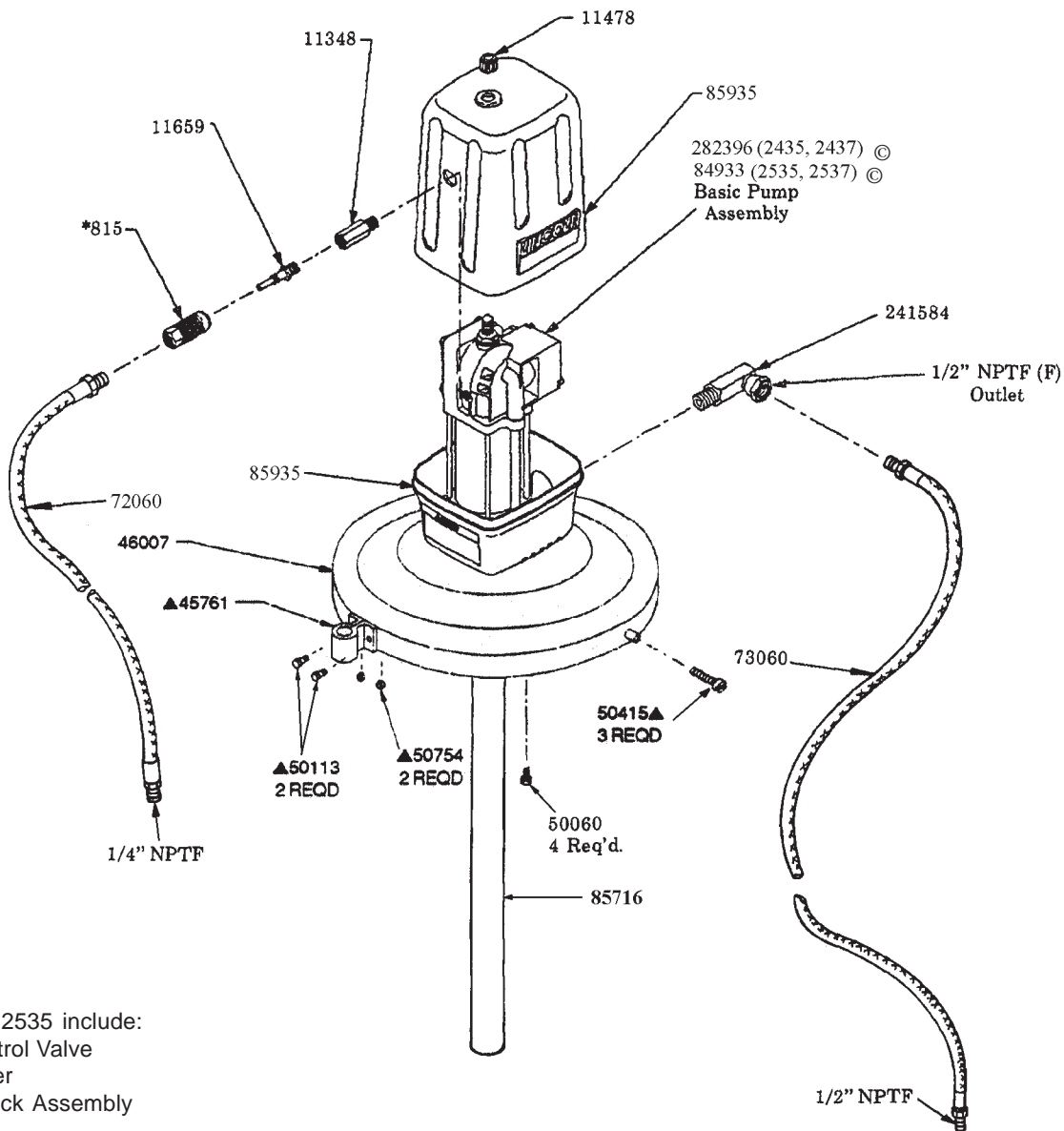

STATIONARY GEAR LUBRIGUN MODELS 2435, 2435LN, 2437 3:1 RATIO MODELS 2535, 2537 5:1 RATIO 16 GAL. DRUM SIZE



2435 and 2535 include:

- * 780 Control Valve
- * 870 Meter
- 80895 Truck Assembly

2435LN includes:

- * 780 Control Valve
- * 873 Meter
- 80895 Truck Assembly

* Refer to separate instructions:

- 815 Air Coupler - Section G9 Page 2 Series
- 282396 Basic Pump - Section A6, Page 37 Series
- 84933 Basic Pump - Section A6, Page 38 Series
- 780 Control Valve - Section F21, Page 11 Series
- 870 Meter - Section F22, Page 2 Series
- 873 Meter - Section F22, Page 20 Series

▲ - Included in 46007 Drum Cover Kit

© Indicates change



One Lincoln Way
St. Louis, MO 63120-1578
Phone +1.314.679.4200
Fax +1.800.424.5359

Section - **A6**

Page - **56A**

SERVICE PARTS

| Part | Qty. | Description | Part | Qty. | Description |
|-------|------|----------------------|--------|------|------------------------------------|
| 815 | 1 | Air Coupler | 50415 | 3 | Slotted Head Screw |
| 11348 | 1 | Adapter | 50754 | 2 | Hex Nut |
| 11478 | 1 | Cover Nut | 72060 | 1 | Air Hose |
| 11659 | 1 | Air Coupler Nipple | 73060 | 1 | Lubricant Hose |
| 45761 | 1 | Control Valve Hanger | 84933 | 1 | Basic Pump Assembly (2535, 2537) © |
| 46007 | 1 | Drum Cover Kit | 85935 | 1 | Airmotor Cover |
| 50113 | 2 | Hex Head Cap Screw | 85716 | 1 | Tube |
| 50060 | 4 | Bolt | 241584 | 1 | Outlet Connection |
| | | | 282396 | 1 | Basic Pump Assembly (2435, 2437) © |

Assembly

Assemble control valve hanger (45761) to drum cover as shown.

Assemble pump to drum cover top with four screws as shown.

If pumping a heavy grease that requires a floolwer, place an optional follower into the grease in the open 120 pound drum.

Place drum cover assembly onto drum. Screw in the three thumb screws to secure drum cover to drum.

Place pump through drum cover and through follower if used.

Assemble delivery hose as shown. Connections must be tight and leak proof.

Screw air nipple into air mtor and attach air coupler to air delivery hose.

Unit is operational when air delivery hose is connected to pump.